

D Sub-Miniature Connectors

The standard series provides a high quality range of D subminiature connectors in 9, 15, 25, 37 and 50 way versions, and with the option of solder bucket, straight and PCB solder, wire wrap, edge mount, SMT, or press fit termination styles all of which are offered with a wide range of plating options. Connector shells are finished with tin plate over nickel or yellow chromate over zinc. Polarisation is achieved by the keystone shape of the mating plug and socket.

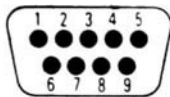

Contact Arrangements



Size 1 = 9 contacts

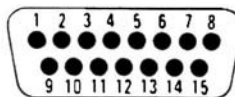

Size 2 = 15 contacts

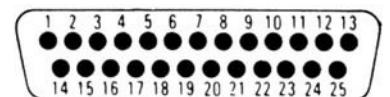

Size 3 = 25 contacts

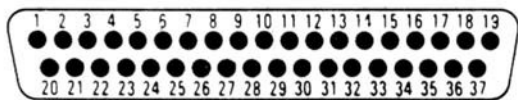

Size 4 = 37 contacts

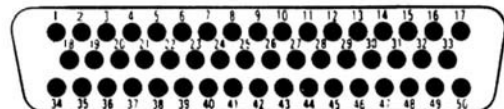

Size 5 = 50 contacts

Note: view as seen from back of socket

Materials and Finishes

- Insulator: thermoplastic rated UL94 V-O
- Shell: steel, yellow chromate or tin plate finish
- Contacts: copper alloy, screw machined or stamped, with gold, tin or selective plating

Operating Characteristics

- Current rating:
Machine contacts: 5 Amps typically
Stamped contacts: 3 Amps typically
- Temperature range: -55°C to 155°C typically
- Operating voltage: 250 V
- Resistance: per mated contact pair max. 35m ohm (MIL-C-24308)
- Insulation resistance: 5000M ohm per mated contact pair
- Volume resistance: 10⁶ ohm cm (ASTM-D257)
- Dielectric strength: 50 kV/mm

Termination Styles - straight contacts

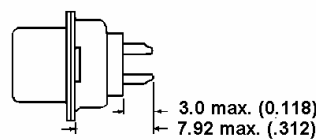

Style S
Solder Bucket

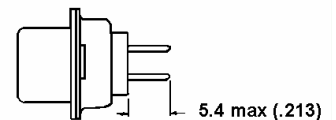

Style P
Printed Circuit
0.6 (.024) dia.

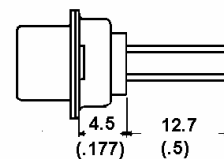

Style W
Wire Wrap
0.6 (.024) square

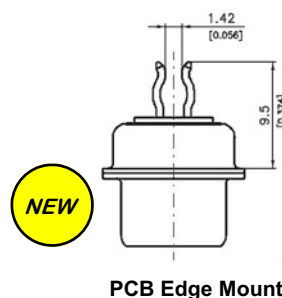

PCB Edge Mount

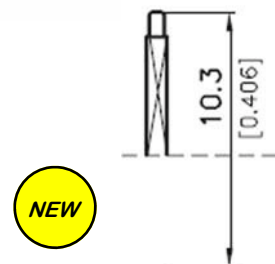

Style H
Press Fit
0.8mm (0.031") square

D Sub-Miniature Connectors Right Angle PCB Mounting Termination Styles:- Turned Pin Contacts

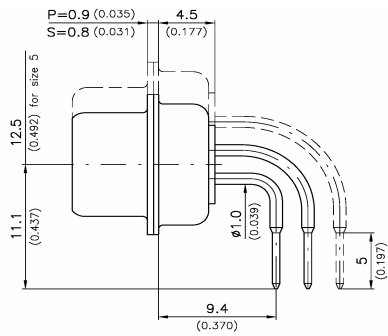

STYLE A
Spacing 2.54mm (0.100")
Pin Ø 0.6mm (0.024")

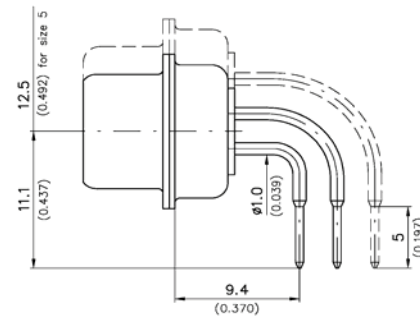

STYLE B
Spacing 2.84mm (0.112")
Pin Ø 0.6mm (0.024")

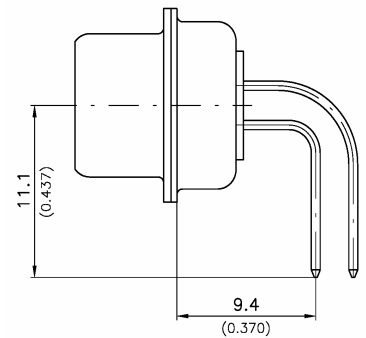

STYLE F
Spacing 2.54mm (0.100")
Pin Ø 0.6mm (0.024")

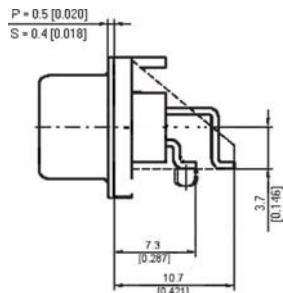

STYLE K—SMT

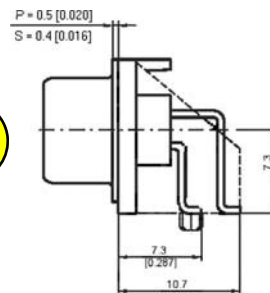

STYLE N

Ordering Code Straight & Right Angle

D S S - 15 - S D 1 (012)

Series:

D = D Subminiature

Product Gender:

P = Plus

S = Socket

Product Version:

S = Standard version with screw machined captive contacts

B = Low cost version with screw machined captive contacts

L = Standard version with stamped and formed captive contacts

A = SMT

No. of contacts:

9, 15, 25, 37, 50

Termination Style:

S = Solder Bucket

P = Straight PCB

W = Wire Wrap

H = Straight Press Fit

A = Right Angle PCB 2.54mm (0.100") spacing; pin Ø 0.6mm (0.024")

B = Right Angle PCB 2.84mm (0.112") spacing; pin Ø 0.6mm (0.024")

F - Right Angle PCB 21.54mm (0.100") spacing; pin Ø 0.6mm (0.024") over entire length

J - PCB Edge Mount 1.6mm thick

K - Low Profile (3.7mm PCB to centre line) SMT right angle

N - Std. profile (7.3mm PCB to centre line) SMT right angle

Contact Plating:

A = 0.2 microns (0.000008") Au over nickel

D = Gold flash over nickel

Mounting Style:

1 = Standard flanged mounting

2 = Float mount rear panel mounting

3 - Float mount front panel mounting

12 - 4-40 UNC clinch nuts, rear mounted for other styles refer to examples see over

Modification Code:

(011) = Socket with tin plated shell

(012) = Plug with tin plated indented shell